

# OXFORD STREET

## S. ANTHONY BLVD. TO TURPIE ST.

### CONCRETE RECONSTRUCTION

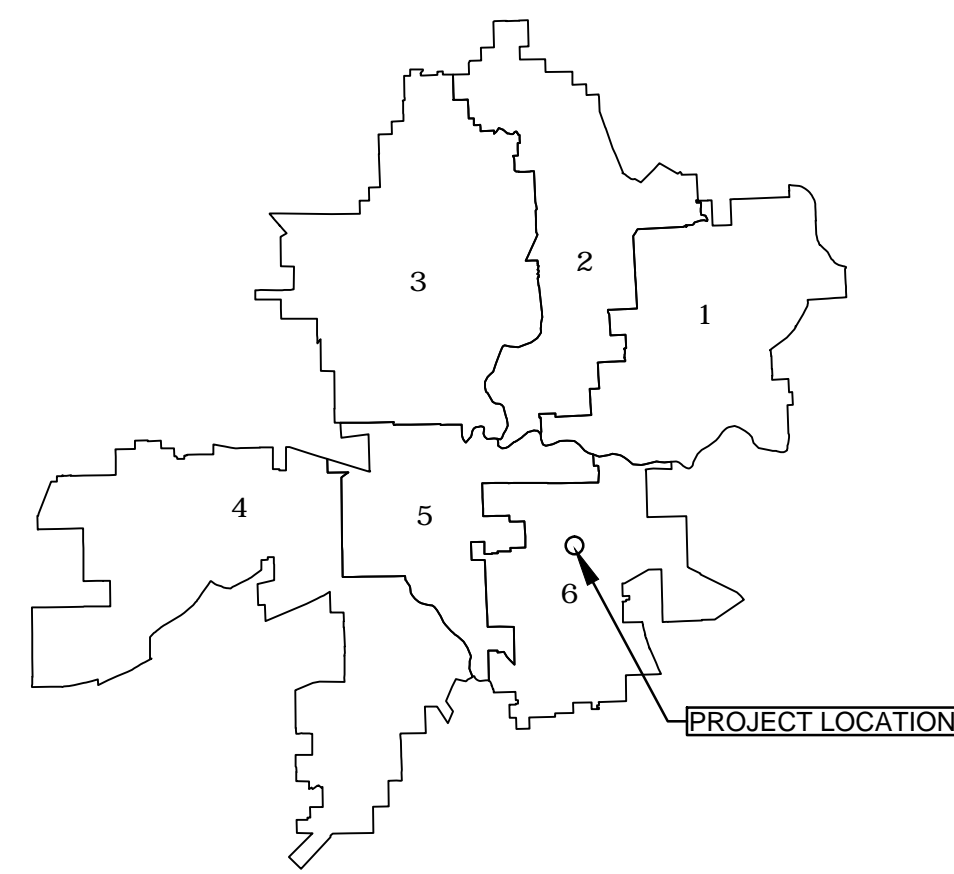

CITY OF FORT WAYNE  
COUNCIL DISTRICTS

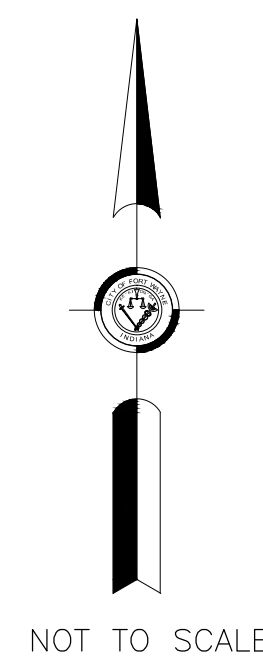

LOCATION MAP

Sheet List Table	
Sheet Number	Sheet Title
1	TITLE
2	PLAN VIEW
3	PLAN VIEW
4	PLAN VIEW
5	PLAN VIEW
6	DETAILS
7	DETAILS
8	PVMNT MRK

MAYOR  
HONORABLE THOMAS C. HENRY  
THE BOARD OF PUBLIC WORKS

ROBERT P. KENNEDY  
CHAIR  
KUMAR MENON  
MEMBER  
MIKE AVILA  
MEMBER

COMMON COUNCIL REPRESENTATIVE

GLYNN HINES  
DISTRICT 6

PLANS CERTIFIED BY:

SHAN GUNAWARDENA, P.E., P.T.O.E.  
CITY ENGINEER

This \_\_\_\_\_ Day Of \_\_\_\_\_ 20\_\_

DRAFTING SCHEDULE			
NO.	DATE	DESCRIPTION	BY
1	11/25/13	PRELIMINARY	JD
2	4/10/14	DESIGN	JD
3	6/10/14	FINAL PLANS	JD
4			
5			
6			
7			
8			

-- REVISIONS --			
NO.	DATE	DESCRIPTION	BY

TRANSPORTATION ENGINEERING SERVICES		CITIZENS SQUARE, 200 EAST BERRY STREET 46802	
OXFORD STREET S. ANTHONY BLVD. TO TURPIE ST. CONCRETE RECONSTRUCTION			
Designed by: K. OKLESCHEN	RES.	W.O.	S.T.
Drawn by: J. DeARMOND	12344		Sheet <u>1</u> of <u>8</u>
Checked by: M. TREVINO			

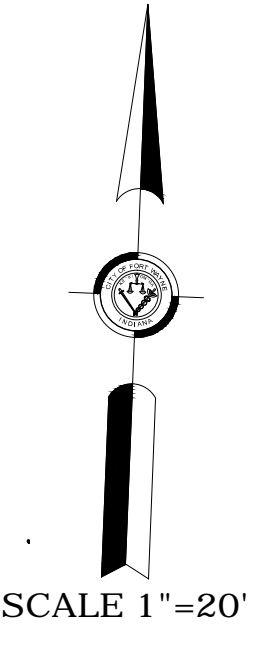
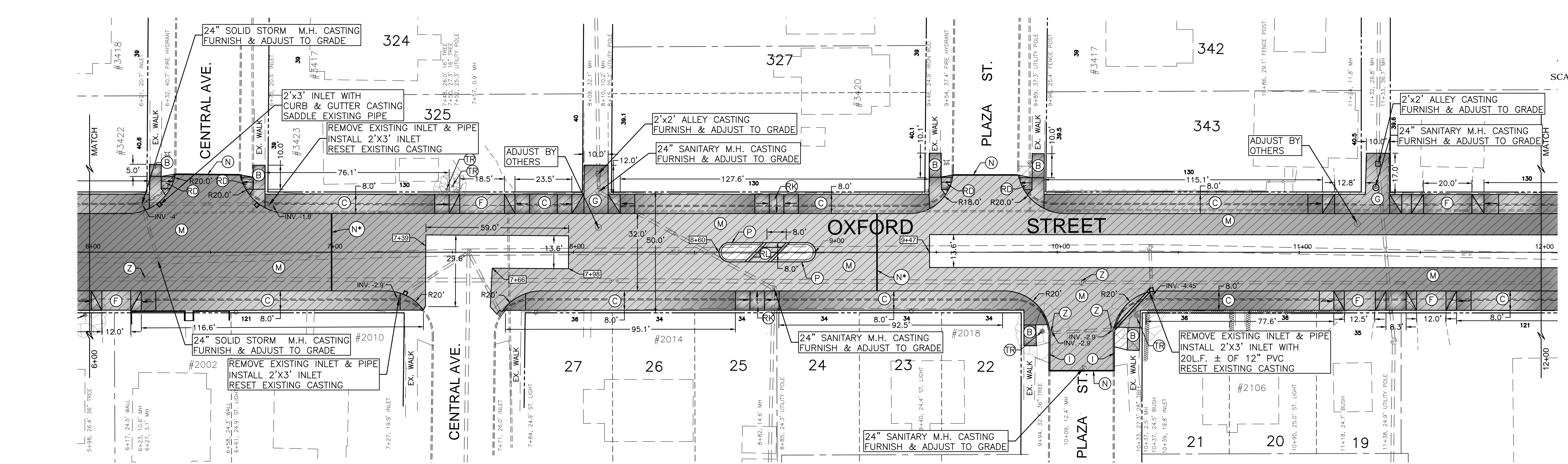
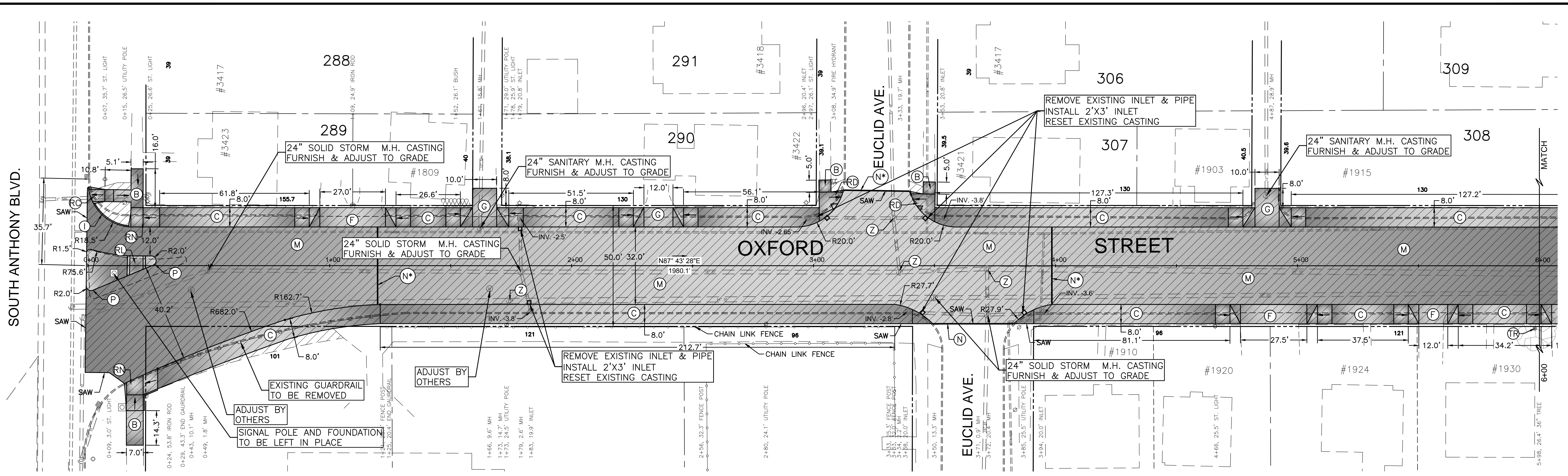

NOTE:  
 THE LOCATIONS OF UNDERGROUND UTILITIES AS SHOWN ARE APPROXIMATE. THEIR LOCATIONS WERE DETERMINED FROM INFORMATION PROVIDED BY THE SURVEY OR AVAILABLE MAPPING. ALL LOCATIONS SHALL BE FIELD VERIFIED BY CONTRACTOR BEFORE EXCAVATING.

- LEGEND**
- NEW CONSTRUCTION
  - REMOVAL
  - (A) REMOVAL OF CURB
  - (B) CONCRETE SIDEWALK (4")
  - (C) CONCRETE FOR CURBFACE SIDEWALK (4")
  - (F) CONCRETE FOR RESIDENTIAL DRIVES (6")
  - (G) CONCRETE FOR COMMERCIAL & ALLEY DRIVES (8")
  - (H) CONCRETE CURB TYPE III
  - (L) CONCRETE CURB TYPE II-A
  - (M) CEMENT CONCRETE PAVEMENT, PLAIN 9"
  - (N) 1" EXPANSION JOINT (\*W/LOAD TRANSFER)
  - (P) "SPECIAL" CONCRETE CURB FOR MEDIAN
  - (C) CURB RAMP, TYPE "C"
  - (D) CURB RAMP, TYPE "D"
  - (F) CURB RAMP, TYPE "F"
  - (K) CURB RAMP, TYPE "K"
  - (N) CURB RAMP, TYPE "N"
  - (Z) ADJUST CASTING TO GRADE

<b>OXFORD STREET</b>		
S. ANTHONY BLVD. TO TURPIE ST.		
CONCRETE RECONSTRUCTION		
Designed by: K. OKLESCHEN	RES. W.O.	S.T.
Drawn by: J. DEARMOND	12344	
Checked by: M. TREVINO	Sheet 2 of 8	

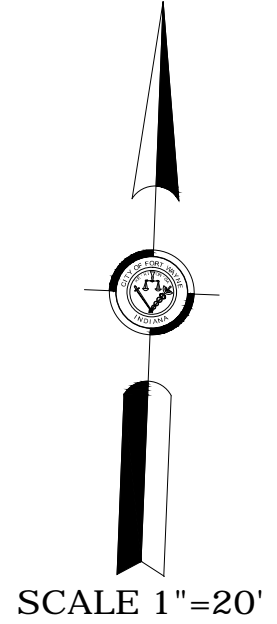
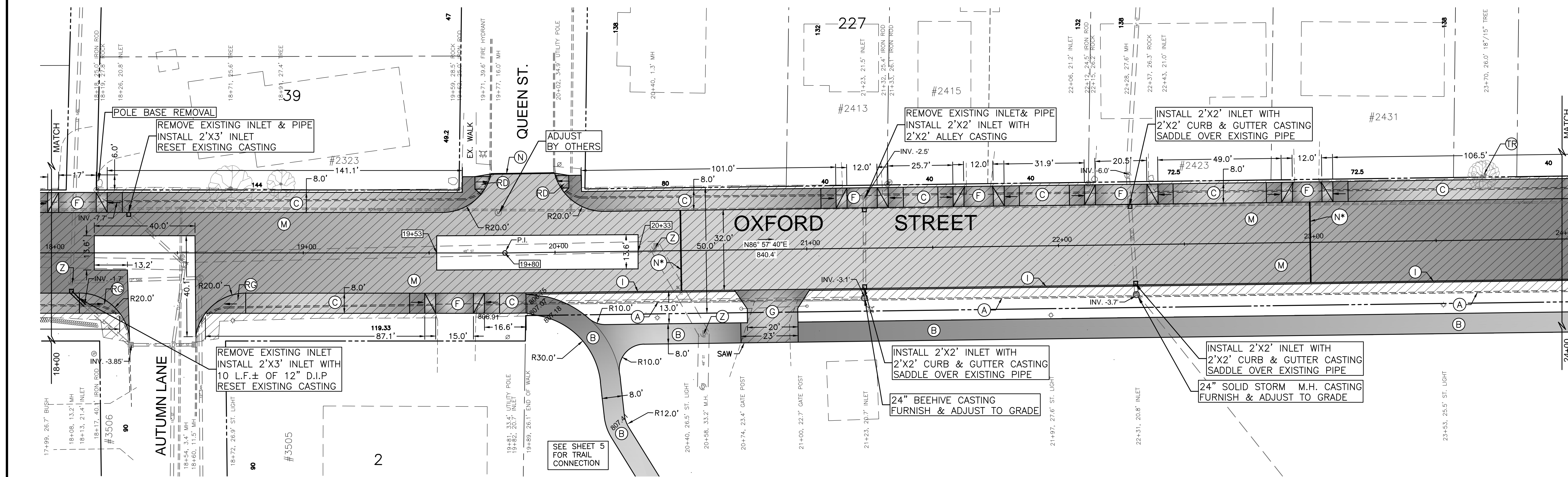
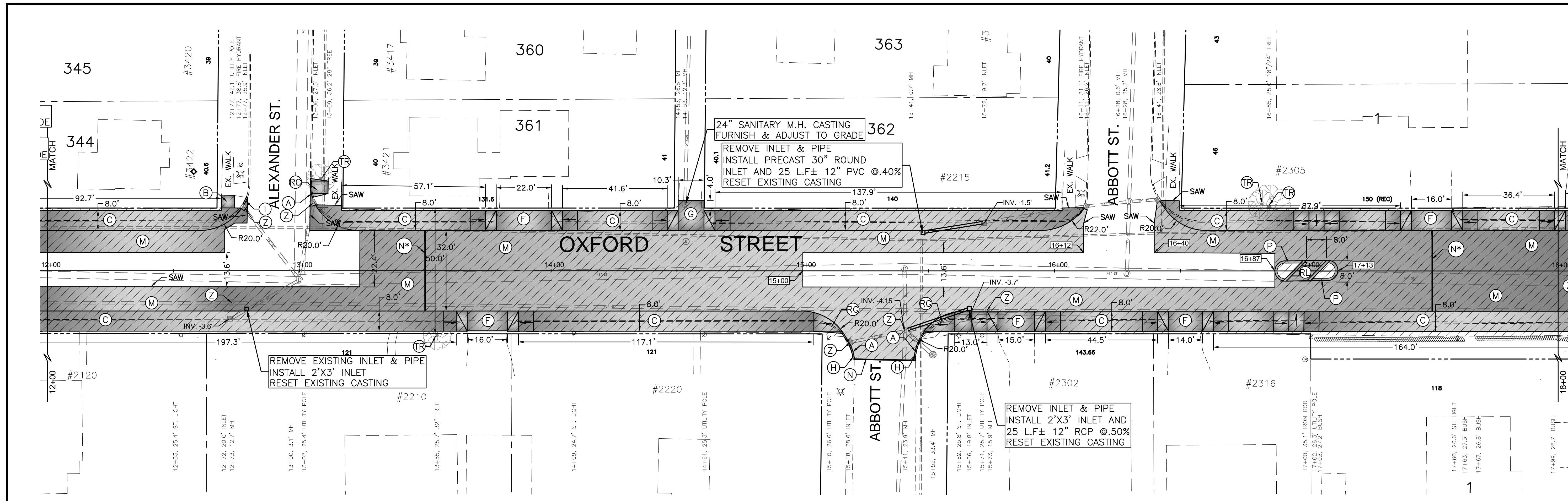

**LEGEND**

- NEW CONSTRUCTION
- REMOVAL
- (A) REMOVAL OF CURB
- (B) CONCRETE SIDEWALK (4")
- (C) CONCRETE FOR CURBSIDE SIDEWALK (4")
- (F) CONCRETE FOR RESIDENTIAL DRIVES (6")
- (G) CONCRETE FOR COMMERCIAL & ALLEY DRIVES (8")
- (H) CONCRETE CURB TYPE III
- (I) CONCRETE CURB TYPE II-A
- (M) CEMENT CONCRETE PAVEMENT, PLAIN 9"
- (N) 1" EXPANSION JOINT (\*W/LOAD TRANSFER)
- (P) "SPECIAL" CONCRETE CURB FOR MEDIAN
- (RC) CURB RAMP, TYPE "C"
- (RD) CURB RAMP, TYPE "D"
- (RF) CURB RAMP, TYPE "F"
- (RK) CURB RAMP, TYPE "K"
- (RN) CURB RAMP, TYPE "N"
- (Z) ADJUST CASTING TO GRADE

NOTE:  
THE LOCATIONS OF UNDERGROUND UTILITIES AS SHOWN ARE APPROXIMATE. THEIR LOCATIONS WERE DETERMINED FROM INFORMATION PROVIDED BY THE SURVEY OR AVAILABLE MAPPING. ALL LOCATIONS SHALL BE FIELD VERIFIED BY CONTRACTOR BEFORE EXCAVATING.

<b>OXFORD STREET</b>		
S. ANTHONY BLVD. TO TURPIE ST.		
CONCRETE RECONSTRUCTION		
Designed by: K. OKLESCHEN	RES. W.O.	S.T.
Drawn by: J. DEARMOND	12344	
Checked by: M. TREVINO	Sheet 3 of 8	

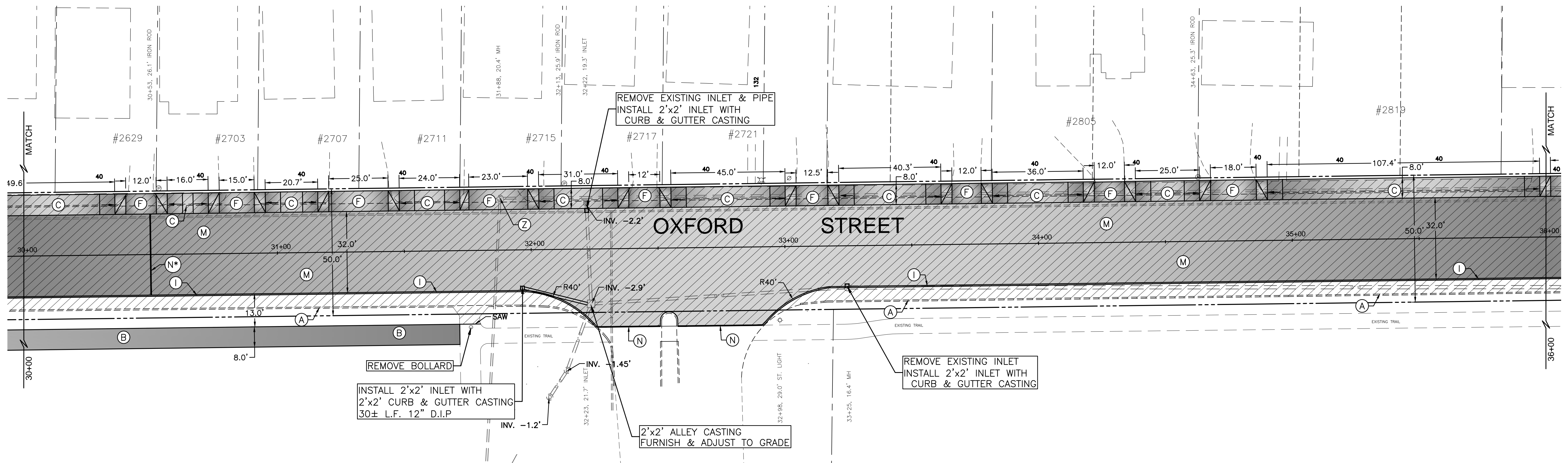
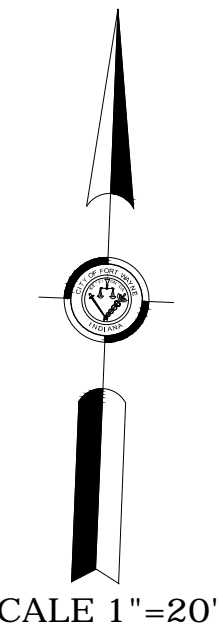
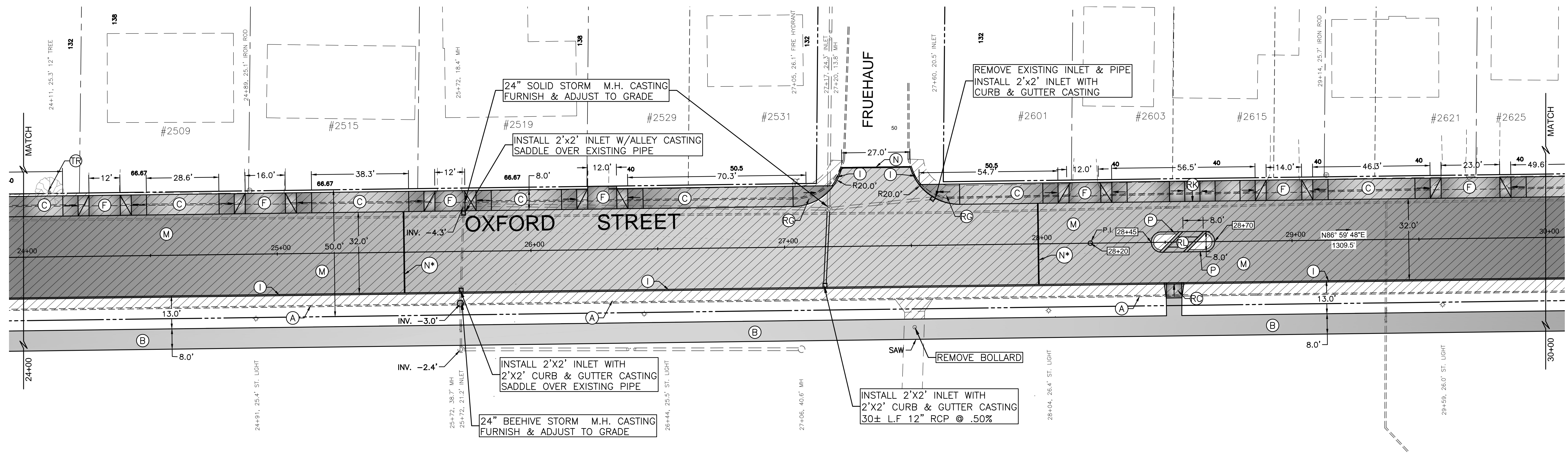

NOTE:  
THE LOCATIONS OF UNDERGROUND UTILITIES AS SHOWN ARE APPROXIMATE. THEIR LOCATIONS WERE DETERMINED FROM INFORMATION PROVIDED BY THE SURVEY OR AVAILABLE MAPPING. ALL LOCATIONS SHALL BE FIELD VERIFIED BY CONTRACTOR BEFORE EXCAVATING.

- LEGEND**
- NEW CONSTRUCTION
  - REMOVAL
  - (A) REMOVAL OF CURB
  - (B) CONCRETE SIDEWALK (4")
  - (C) CONCRETE FOR CURBFACE SIDEWALK (4")
  - (F) CONCRETE FOR RESIDENTIAL DRIVES (6")
  - (G) CONCRETE FOR COMMERCIAL & ALLEY DRIVES (8")
  - (H) CONCRETE CURB TYPE III
  - (I) CONCRETE CURB TYPE II-A
  - (M) CEMENT CONCRETE PAVEMENT, PLAIN 9"
  - (N) 1" EXPANSION JOINT (\*W/LOAD TRANSFER)
  - (P) "SPECIAL" CONCRETE CURB FOR MEDIAN
  - (RC) CURB RAMP, TYPE "C"
  - (RD) CURB RAMP, TYPE "D"
  - (RF) CURB RAMP, TYPE "F"
  - (RK) CURB RAMP, TYPE "K"
  - (RN) CURB RAMP, TYPE "N"
  - (Z) ADJUST CASTING TO GRADE

<b>OXFORD STREET</b>		
S. ANTHONY BLVD. TO TURPIE ST.		
CONCRETE RECONSTRUCTION		
Designed by: K. OKLESCH	RES. W.O.	S.T.
Drawn by: J. DEARMOND	12344	
Checked by: M. TREVINO	Sheet 4 of 8	

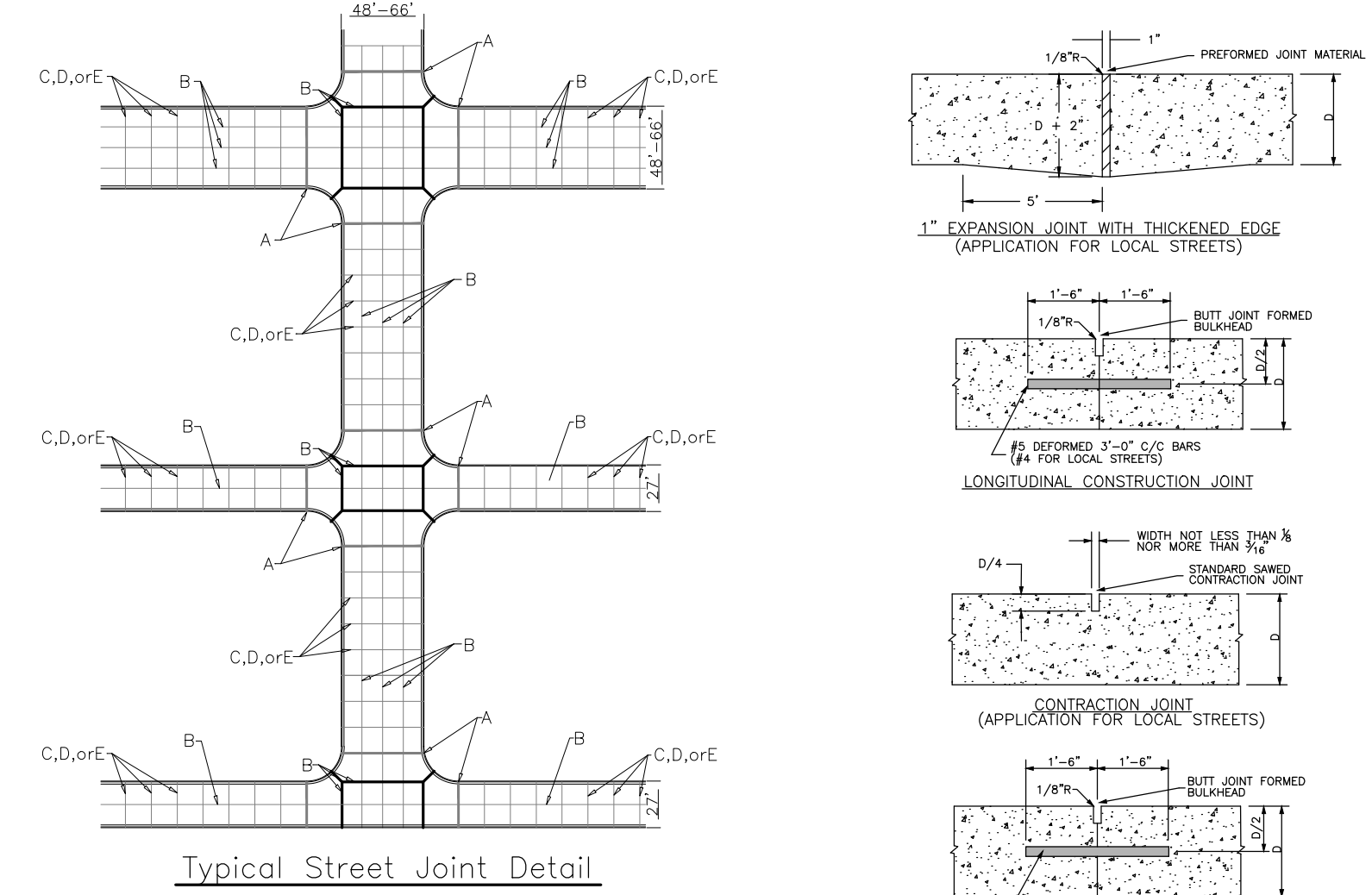
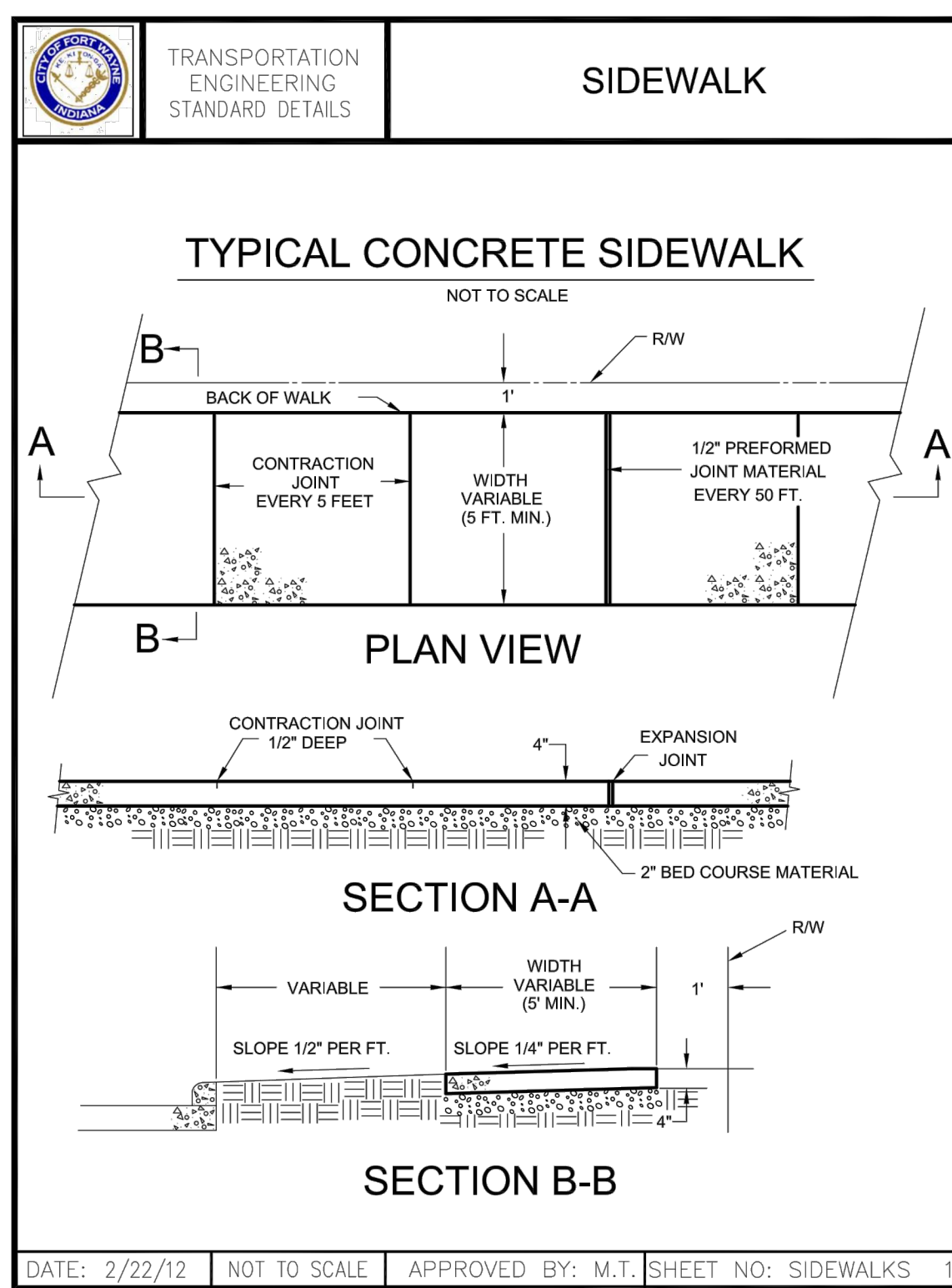
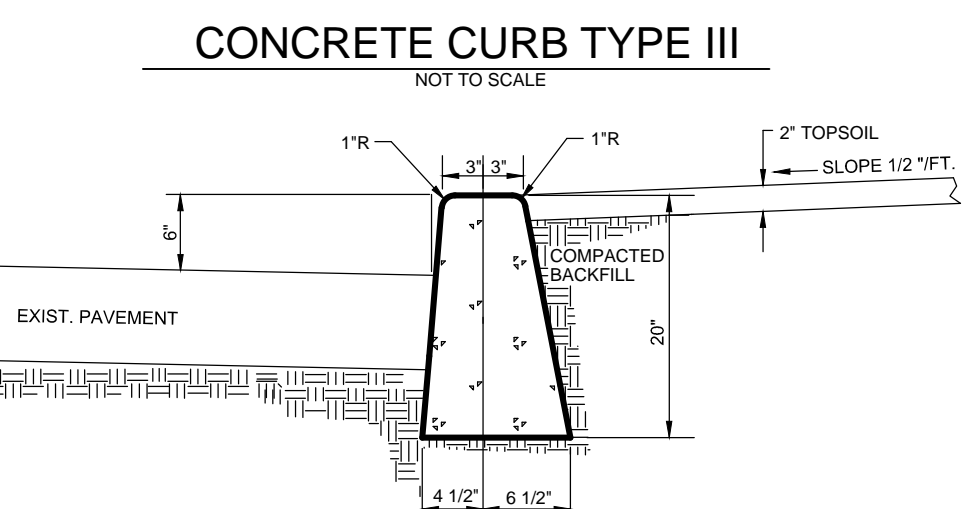
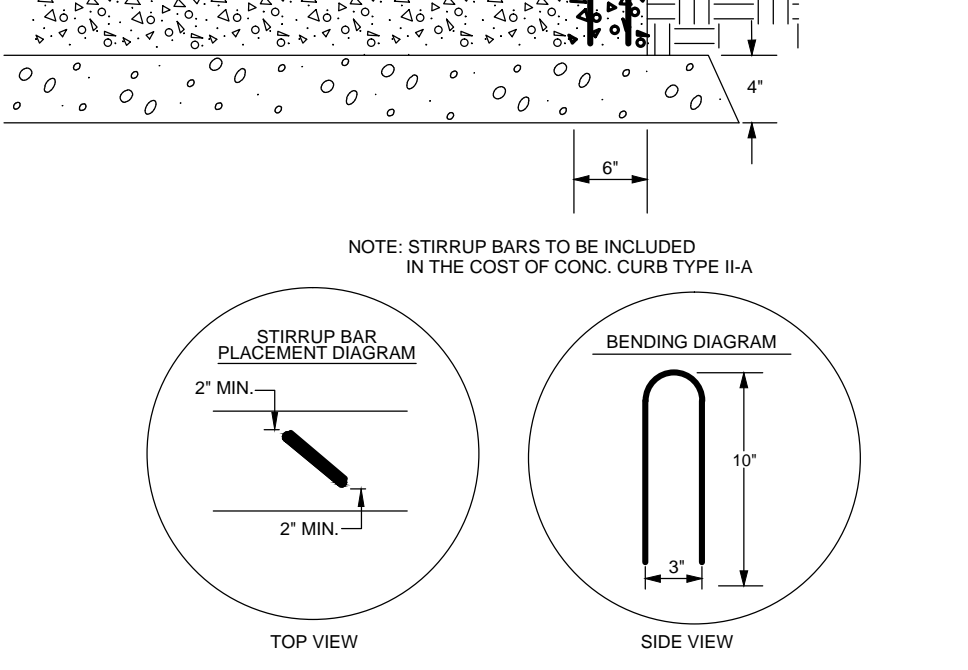
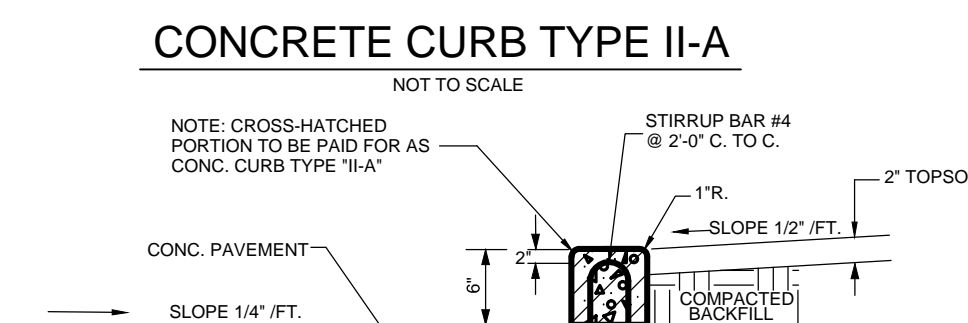
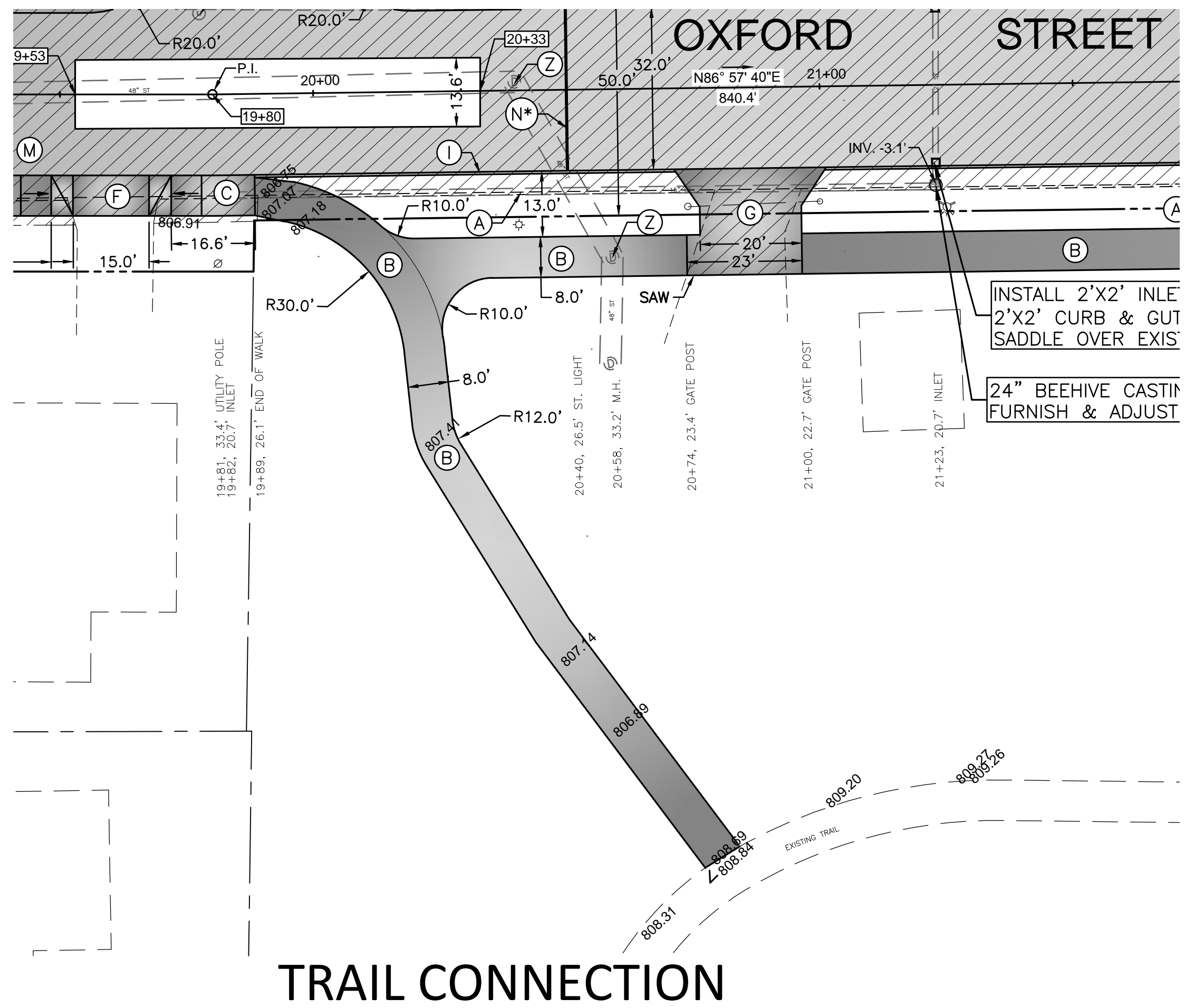
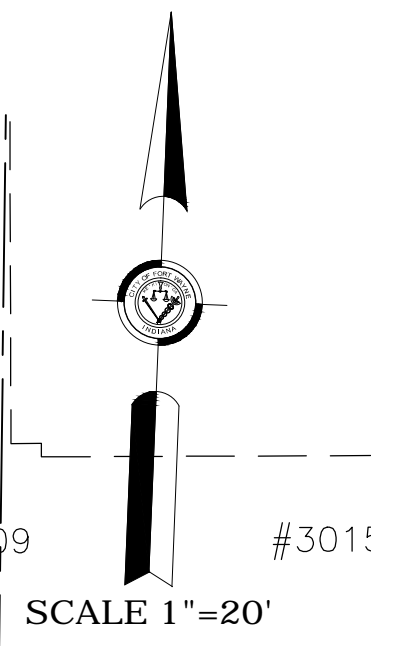
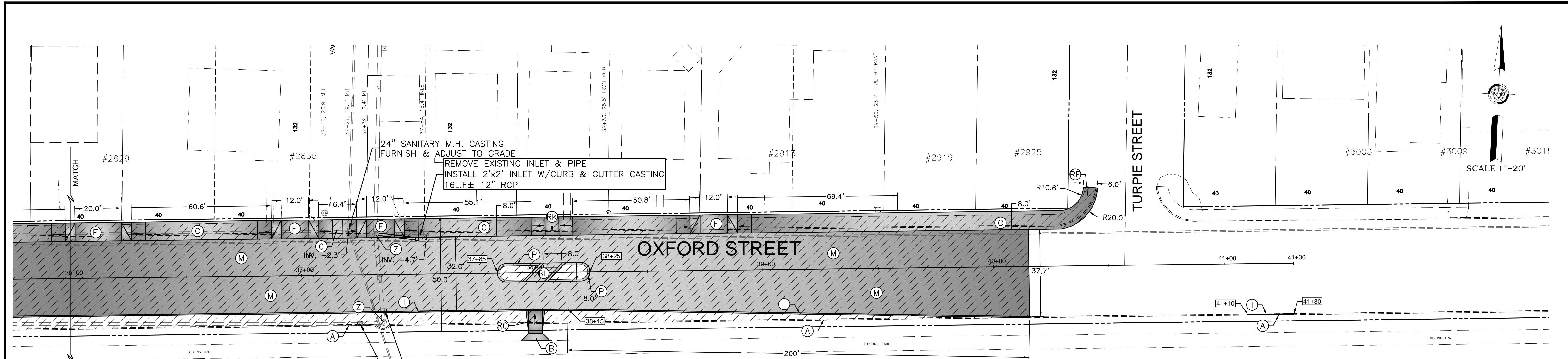

A Type 1" Expansion Joint With Thickened Edge	
Pavement Thickness	Thickened Edge
7"	9"
9" To 12"	11"

Type 1" Expansion Joint with Load Transfer			
Pavement Thickness	Min. Dowel Bar Size	Length	Spacing-Placed @ 6" From Pavement Edge
9" To 12"	1-1/4"	1'-6"	1'-0" c/c

B Tie-Bar Sizes For Longitudinal Joint			
Pavement Thickness	Tie Bar Size	Length	Spacing-Placed @ 1'-6" From Transverse Joint
7"	#4 (1/2" dia.)	3'-0"	3'-0" c/c
9" To 12"	#5 (5/8" dia.)	3'-0"	3'-0" c/c

C Dowel Bar Sizes For Transverse D-1 Joints			
Pavement Thickness	Min. Dowel Bar Dia.	Length	Spacing-Placed @ 6" From Pavement Edge
9" To 12"	1-1/4"	1'-6"	1'-0" c/c

D Contraction Joint	
Pavement Thickness	Joint Spacing
7"	12'-0" To 15'-0"
8" To 12"	15'-0" To 18'-0"

E Tie-Bar Sizes For Transverse Construction Joint			
Pavement Thickness	Tie-Bar Size	Length	Spacing-Placed @ 6" From Pavement Edge
7"	#4 (1/2" dia.)	3'-0"	2'-0" c/c
9" To 12"	#5 (5/8" dia.)	3'-0"	2'-0" c/c

Typical Street Joint Table

NOTE: THE LOCATIONS OF UNDERGROUND UTILITIES AS SHOWN ARE APPROXIMATE. THEIR LOCATIONS WERE DETERMINED FROM INFORMATION PROVIDED BY THE SURVEY OR AVAILABLE MAPPING. ALL LOCATIONS SHALL BE FIELD VERIFIED BY CONTRACTOR BEFORE EXCAVATING.

- NEW CONSTRUCTION
- ▨ REMOVAL
- (A) REMOVAL OF CURB
- (B) CONCRETE SIDEWALK (4")
- (C) CONCRETE FOR CURBSIDE SIDEWALK (4")
- (F) CONCRETE FOR RESIDENTIAL DRIVES (6")
- (G) CONCRETE FOR COMMERCIAL & ALLEY DRIVES (8")
- (H) CONCRETE CURB TYPE III
- (I) CONCRETE CURB TYPE II-A
- (M) CEMENT CONCRETE PAVEMENT, PLAIN 9"
- (N) 1" EXPANSION JOINT (\*W/LOAD TRANSFER)
- (P) "SPECIAL" CONCRETE CURB FOR MEDIAN
- (R) CURB RAMP, TYPE "C"
- (R1) CURB RAMP, TYPE "D"
- (R2) CURB RAMP, TYPE "F"
- (R3) CURB RAMP, TYPE "K"
- (R4) CURB RAMP, TYPE "N"
- (Z) ADJUST CASTING TO GRADE

LEGEND

**OXFORD STREET**  
S. ANTHONY BLVD. TO TURPIE ST.  
CONCRETE RECONSTRUCTION

Designed by: K. OKLESHEN	RES.	W.O.	S.T.
Drawn by: J. DEARMOND	12344		
Checked by: M. TREVINO	Sheet 5 of 8		